

Dimension: (UNIT:mm)

A	50.0 ± 0.8
B	25.0 ± 0.3
C	10.0 ± 0.3
D	17.0 ± 0.3
E	35 ± 0.08
F	23.0 ± 0.3
G	6.0 ± 0.2
H	

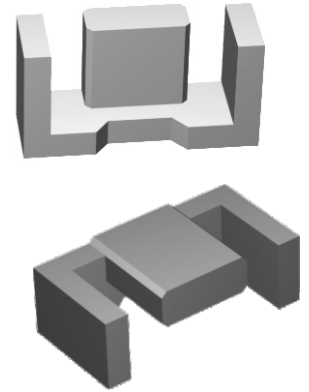
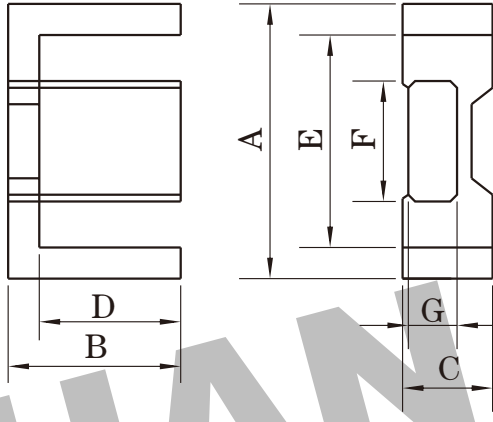

Test conditions

AL: F=1.0KHz U=0.3V N=10Ts

Effective parameter

C1(mm) ⁻¹	Ae(mm ²)	Le(mm)	Ve(mm ³)	Weight(g)
0.68	151.5	103.3	15463	≈90

Properties of core sets under power conditions

Core sets

Clamping force for Al measurements, 20+/-10N

Grade	AL (nH)	μe	AIR GAP μm	Type number
P3	1400 ± 25%	≈ 1980	≈ 0	EFD50-P3
P4	1400 ± 25%	≈ 1980	≈ 0	EFD50-P4
HQ2KA	1310 ± 25%	≈ 1820	≈ 0	EFD50-HQ2KA
HQ2K	1310 ± 25%	≈ 1820	≈ 0	EFD50-HQ2K
P5	1050 ± 25%	≈ 1450	≈ 0	EFD50-P5

Grade	B (mT)at	Core loss (w) at			
	H=250 A/m F=25KHz T=100℃	F=25 KHz B=200mT T=100℃	f=100 KHz B=100mT T=100℃	F=100 KHz B=200mT T=100℃	F=400 KHz B=50mT T=100℃
P3	≥ 330	≤ 0.8	≤ 0.84	-	-
P4	≥ 330	-	≤ 0.73	≤ 3.9	-
HQ2KA	≥ 340	-	≤ 0.62	≤ 3.1	≤ 1.2
HQ2K	≥ 315	-	≤ 0.64	-	≤ 1.3
P5	≥ 300	-	-	-	≤ 0.5

Properties of core sets under power conditions (continued)

Grade	B (mT)at	Core loss (w) at				
	H=250 A/m F=25KHz T=100℃	F=500 KHz B=50mT T=100℃	F=500 KHz B=100mT T=100℃	F=1.0 MHz B=30mT T=100℃	F=1.0MHz B=50mT T=100℃	F=3.0MHz B=10mT T=100℃
P3	≥ 330	-	-	-	-	-
P4	≥ 330	-	-	-	-	-
HQ2KA	≥ 340	≤ 2.8	-	-	-	-
HQ2K	≥ 315	-	-	-	-	-
P5	≥ 300	≤ 0.9	≤ 6.3	-	-	-

Note:

- 1: Document is the property of FUAN Inc & is not allow to be duplicated without authorization
- 2: RoHS compliant.